

**CABINET MEMBER FOR ENVIRONMENT – 12 JULY 2018**

**ABINGDON & RADLEY: DUNMORE ROAD, OXFORD ROAD & TWELVE ACRE DRIVE – PROPOSED TOUCAN & PEGASUS CROSSINGS AND BUS STOP CLEARWAYS**

**Report by Director for Infrastructure Delivery**

**Introduction**

1. This report presents responses received to a statutory consultation on a proposal to introduce toucan crossings (signalled crossings for pedestrians and pedal cyclists), a Pegasus crossing (a signal controlled crossing for horse riders) and bus stop clearways at Dunmore Road, Oxford Road and Twelve Acre Drive at Abingdon and Radley.

**Background**

2. The above proposals have been put forward as part of a proposed residential development off Dunmore Road, Oxford Road and Twelve Acre Drive. Plans showing the proposals are provided at Annexes 1 to 4.

**Consultation**

3. Formal consultation on the proposal was carried out between 25 April and 25 May 2018. A public notice was placed in the Abingdon Herald newspaper, and sent to statutory consultees, including Thames Valley Police, the Fire & Rescue Service, Ambulance service, the Vale of the White Horse District Council, Abingdon Town Council, Radley Parish Council and local County Councillors. Street notices were placed in the vicinity of the proposed crossing locations.
4. Four separate responses were received in total, comprising of:

<b>Crossing Location</b>	<b>Support</b>	<b>Object</b>	<b>No objection / opinion</b>
Dunmore Road (East)	2	1	1
Dunmore Road (West)	2	1	1
Dunmore Road Pegasus	2	1	1
Twelve Acre Drive	2	-	2
Oxford Road	2	-	2

5. These responses are summarised at Annex 5 with copies of the full responses available for inspection by County Councillors.

### **Response to objection and other comments**

6. Thames Valley Police (TVP) did not object but raised concerns regarding the speed of traffic in the vicinity of the proposed Oxford Road crossing specifically. They were also keen that the crossing should not be implemented until work had begun, due to some of the proposals currently leading to open farm land.
7. In response to TVP's concerns, speed surveys have been carried out and the correct vision splays will be achieved. The Oxford Road toucan crossing will sit within a proposed 40mph which will be the subject of consultation. Implementation of the Oxford Road crossing, along with all the others, will not take place until the infrastructure around them has been installed.
8. The 'North Abingdon Local Planning Group' welcomed the crossings, citing that they will provide necessary pedestrian, cycle and the occasional horse access to and from the new North Abingdon estate. However, they did raise a similar concern to TVPs regarding the proposed crossing on Oxford Road and the current 50mph speed limit.
9. The objection received from a local resident was made on the grounds of the positioning of the access points to the new development and their relationship to the location of the proposed crossings, specifically the proposed toucan and Pegasus crossings to the west of Boulter Drive, which were considered to be too close to this junction resulting in a risk to safety and an impact on the flow of traffic in the vicinity. This crossing is, however, positioned approximately 130 metres from the junction and so fully complies with national advice on the siting of signalled crossings in respect of nearby junctions.

### **How the Project supports LTP4 Objectives**

10. The proposals will help facilitate the safe movement of traffic.

### **Financial and Staff Implications (including Revenue)**

11. Funding for the proposed crossings and bus stop clearways has been provided from the developers of land off Dunmore Road, Oxford Road and Twelve Acre Drive.

### **RECOMMENDATION**

12. **The Cabinet Member for Environment is RECOMMENDED to approve proposals to introduce toucan crossings (signalled crossings for pedestrians and pedal cyclists), a Pegasus crossing (a signal controlled crossing for horse riders) and bus stop clearways at Dunmore Road, Oxford Road and Twelve Acre Drive at Abingdon and Radley as advertised.**

## CMDE6

OWEN JENKINS  
Director for Infrastructure Delivery

Background papers:      Plan of proposed waiting restrictions  
   Consultation responses

Contact Officers:            Hugh Potter 07766 998704

July 2018



LOCATION PLAN  
Scale: 1:10000

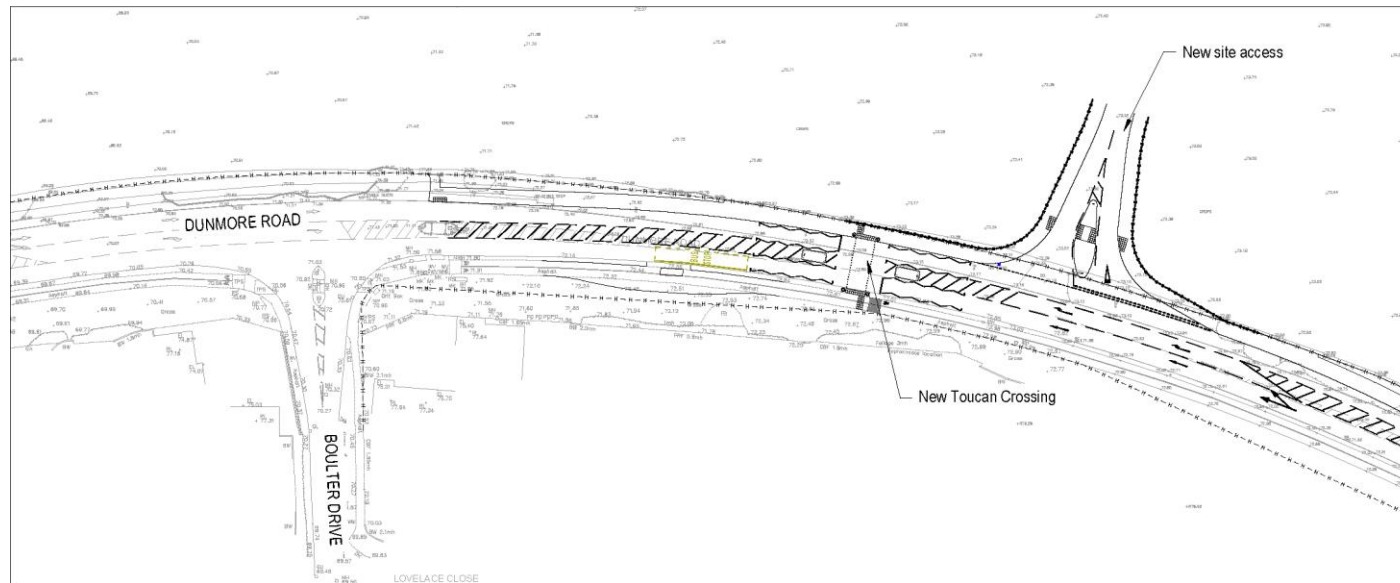

Reproduced from Ordnance Survey digital data with the permission of the Controller of Her Majesty's Stationery Office, Crown copyright (AL814229).



**New Toucan Crossing**  
Dunmore Road, Abingdon  
**CONSULTATION PLAN**



Scale	As shown @ A3
Date	March 2018

CMDE6

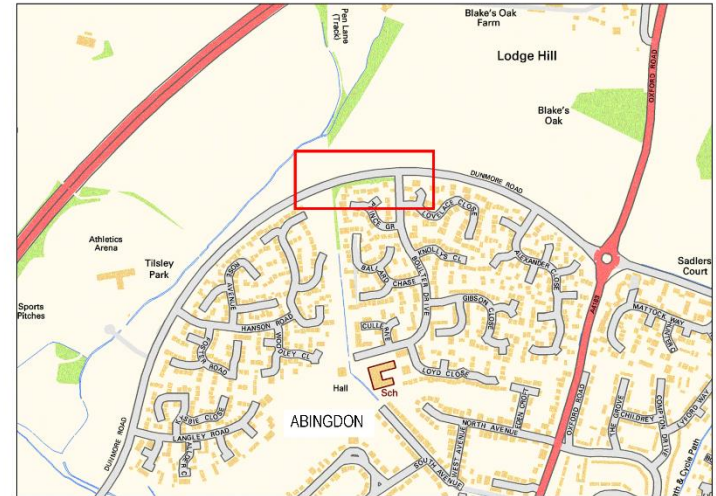

LOCATION PLAN  
Scale: 1:10000

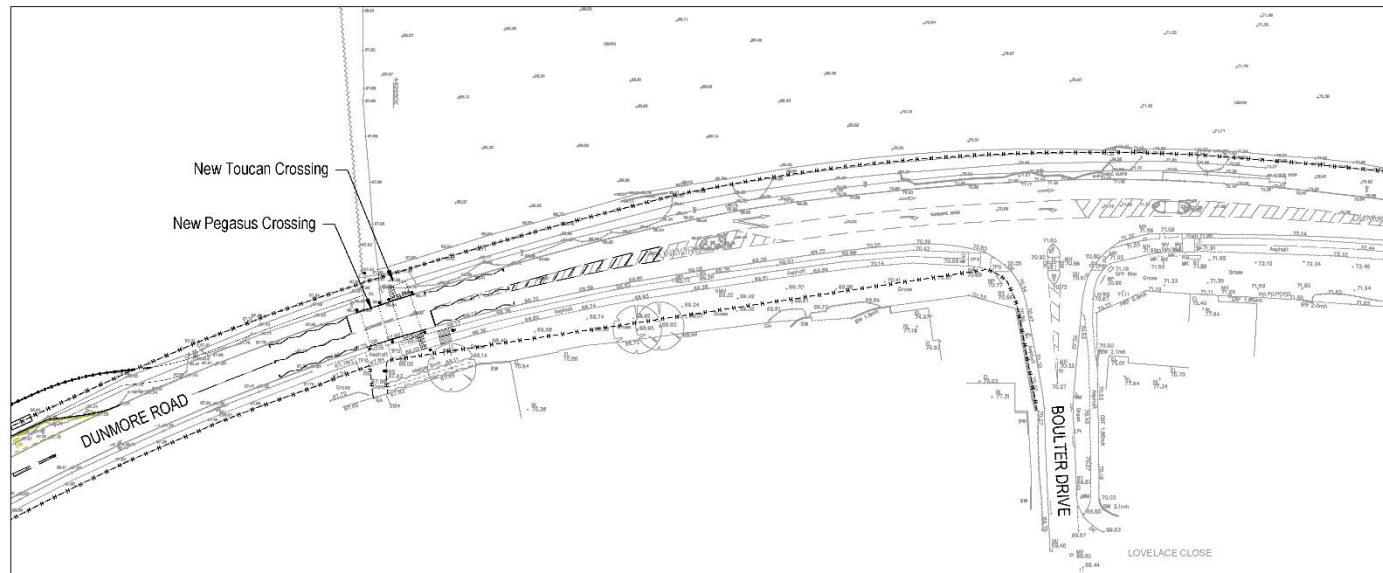

Reproduced from Ordnance Survey digital data with the permission of the Controller of Her Majesty's Stationery Office, Crown copyright (AL814229).

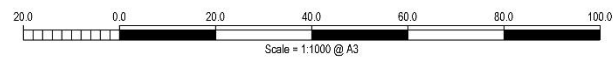

**New Toucan and Pegasus Crossing**

Dunmore Road, Abingdon

**CONSULTATION PLAN**

Scale	As shown @ A3
Date	March 2018

CMDE6

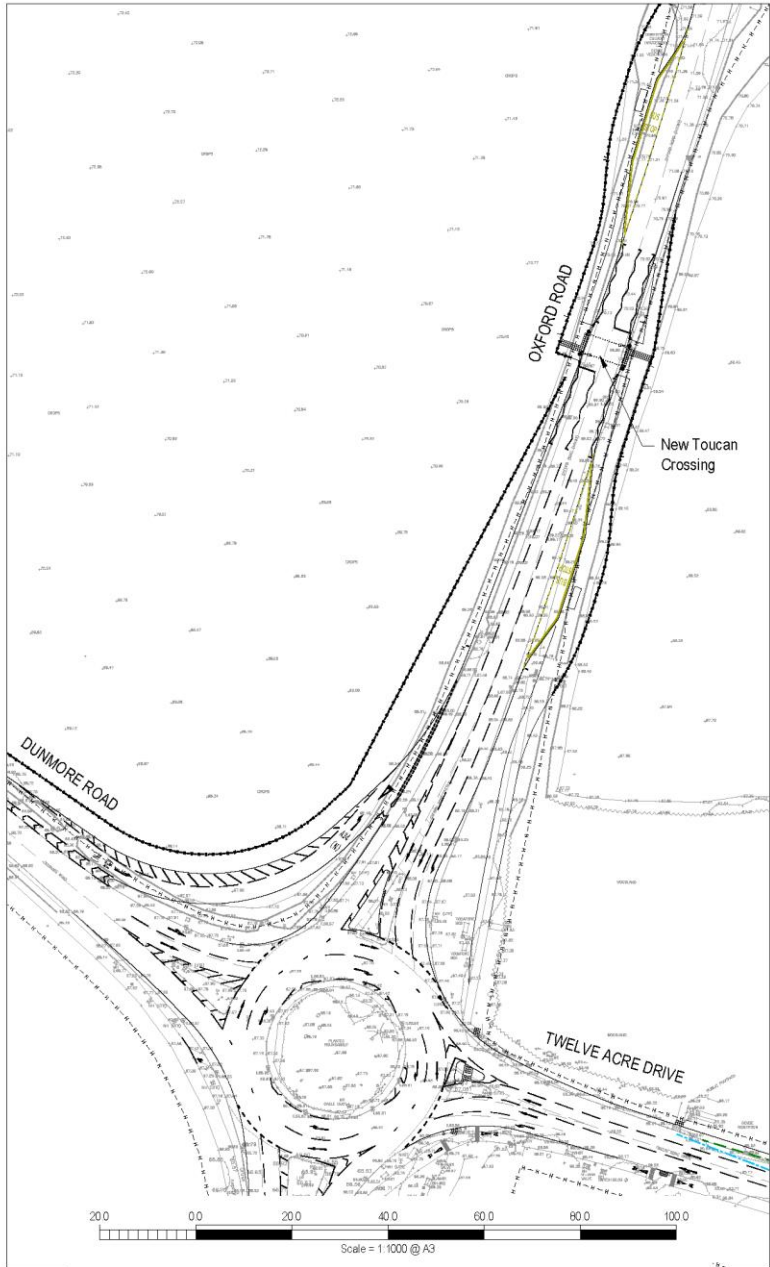

LOCATION PLAN  
Scale: 1:10000

Reproduced from Ordnance Survey digital data with the permission of the Controller of Her Majesty's Stationery Office, Crown copyright (AL814229).



New Toucan Crossing  
Oxford Road, Abingdon  
CONSULTATION PLAN

Scale	As shown @ A3
Date	March 2018





LOCATION PLAN  
Scale: 1:10000

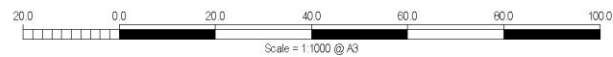
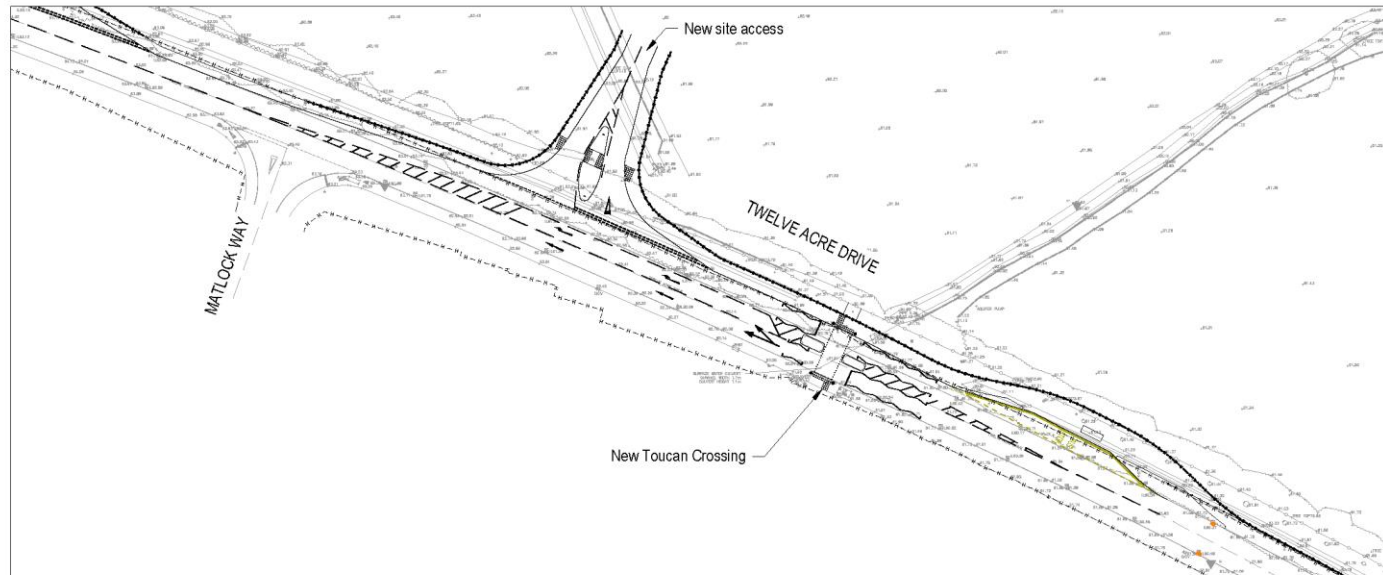

Reproduced from Ordnance Survey digital data with the permission of the Controller of Her Majesty's Stationery Office, Crown copyright (AL814229).



**New Toucan Crossing**  
**Twelve Acre Drive, Abingdon**  
**CONSULTATION PLAN**

Scale	As shown @ A3
Date	March 2018

RESPONDENT	SUMMARISED COMMENTS
(1) Traffic Management Officer, (Thames Valley Police)	<p><b>No objection</b> - I assume that the necessary speed monitoring has already taken place and that all crossings fully meet latest legislative requirements for each individual crossing.</p> <p>In relation to the proposed crossing for Oxford road it is unclear from the current plan where this crossing will sit in relation to the current change in speed limit from 30/50. Are you aware of a proposal to change the position of the speed limit change on this road as part of this new design. In the current layout I fear current approach speeds may already be too high.</p> <p>Can I assume these measures will not be implemented until development begins as the current proposals at some new crossings lead only to open farm land.</p>
(2) Online Response, (unknown)	<p>Dumore Road (East) – <b>Support</b> – <i>No response</i>  Dunmore Road (West) – <b>Support</b> – <i>No response</i>  Dunmore Road Peagasus – <b>Support</b> – <i>No response</i>  Twelve Acre Drive – <b>Support</b> – <i>No response</i>  Oxford Road – <b>Support</b> – <i>No response</i></p>
(3) Local Resident, (Lovlace Close, Abingdon)	<p>Dumore Road (East) – <b>Object</b> – The toucan crossings proposed on the Dunmore Road are based upon the outline plans and the location of the new junction into the development. The location of the junction seems poorly thought through as it is too close to Boulter Drive, which already has significant traffic flows to access the existing school, doctors, chemist, nursery and community centre. Therefore, for safety reasons, impact of traffic flows etc the developers should be asked to rethink where the access points to the development should be positioned - then the location of crossings should be explored. There are other points along the proposed development where an access junction could be put in that is not so close to a busy junction such as Boulter drive. I would hope that the highways department would consider this in their risk/traffic impact assessments and not just accept the developers initial design.</p>

CMDE6

	<p>Dunmore Road (West) – <b>Object</b> – <i>No response</i>  Dunmore Road Peegasus – <b>Object</b> – <i>No response</i>  Twelve Acre Drive – <b>No opinion</b>  Oxford Road – <b>No opinion</b></p>
<p>(4) North Abingdon Local Planning Group, (Boulter Drive, Abingdon)</p>	<p>Dunmore Road (East) – <b>Support</b> – The crossings proposed will provide necessary pedestrian, cycle and the occasional horse access to and from the new North Abingdon estate. They will ease the task of safely crossing Dunmore Road where the Bridle path crosses, which is often difficult. The crossings and related road hatching may slow down and group together the traffic flow on Dunmore Road and Twelve Acre Drive. This might it easier to make right turns onto these roads from the existing estates which is a concern for the existing residents. We will see! NALPG still think that a roundabout would be a better solution than a T junction at the main entrance to the new estate, at the top of the hill, near to the 'Local centre'. NALPG also still think that a wide underpass with an open aspect (as in Milton Keynes) would be a much better option – though expensive - instead of the proposed Toucan crossing on the Oxford Road. The crossing on the Oxford Road will complicate and likely delay traffic flows at the Peachcroft roundabout. People using the crossing will be vulnerable to vehicles speeding down Lodge Hill towards Peachcroft roundabout, so we expect the speed limit of 50mph to be lowered.</p> <p>Dunmore Road (West) – <b>Support</b> – <i>See previous comments</i>  Dunmore Road Peegasus – <b>Support</b> – <i>See previous comments</i>  Twelve Acre Drive – <b>Support</b> – <i>See previous comments</i>  Oxford Road – <b>Support</b> – <i>See previous comments</i></p>